

# Stainless Steel Back Pressure Regulator for Low Pressure

D3110

<b>Description</b>	The diaphragm back pressure regulator protects compressed air devices from excessive pressure. If the pressure setpoint is exceeded, overpressure is vented into the atmosphere until the setpoint is reached again. It is recommended to choose a pressure range as low as possible.
<b>Media</b>	compressed air, gases or liquids
<b>System pressure</b>	max. 6 bar
<b>Adjustment</b>	by adjusting screw, with tamper-proof locknut
<b>Gauge port</b>	G $\frac{1}{4}$ on both sides of the body, screw plugs supplied
<b>Mounting position</b>	any
<b>Temperature range</b>	0 to 60 °C / 32 to 140 °F for NBR/Buna-N, EPDM or FKM, for appropriately conditioned compressed air down to -20 °C / -4 °F
<b>Material</b>	Body: stainless steel 316L, material no. 1.4404 Diaphragm: NBR/Buna-N with PTFE coating, optionally stainless steel O-rings: FKM, optionally NBR/Buna-N or EPDM Inner valve: stainless steel 316L, material no. 1.4404

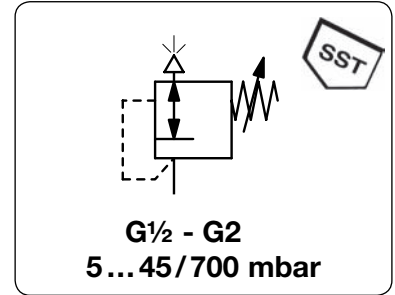

Dimensions			Exhaust rate l/min*1	Over-pressure max. bar	Connection thread G	Adjustment range mbar	Order number
A	B	C					

Back pressure regulator			overpressure max. 6 bar, PTFE diaphragm and FKM o-ring			D3110	
80	170	37	600	6	G $\frac{1}{2}$	5 ... 45	D3110-04AT
						20 ... 200	D3110-04BT
						150 ... 700	D3110-04CT
125	275	66	3000	6	G1	20 ... 50	D3110-08AT
						50 ... 100	D3110-08BT
						100 ... 700	D3110-08CT
215	407	128	2500	6	G2	20 ... 50	D3110-16AT
			5000			50 ... 150	D3110-16BT
			7500			150 ... 300	D3110-16CT
			10000			300 ... 3000	D3110-16DT



D3110-04CT, accessory: gauge

## Special options, add the appropriate letter

<b>NPT</b>	connection thread	D3110-...N
<b>FKM o-ring</b>	at piston regulator or PTFE diaphragm	D3110-...T
<b>NBR/Buna-N o-ring</b>		D3110-...TB
<b>EPDM o-ring</b>		D3110-...TE
<b>nitrogen N<sub>2</sub>: 07</b>	<b>ammonia NH<sub>3</sub>: 02</b>	<b>carbon dioxide CO<sub>2</sub>: 03</b>
<b>argon Ar: 05</b>	<b>helium He: 09</b>	<b>hydrogen H<sub>2</sub>: 11</b>
<b>methane CH<sub>4</sub>: 13</b>	<b>oxygen O<sub>2</sub>: 15</b>	<b>propane C<sub>3</sub>H<sub>8</sub>: 16</b>
<b>nitrous oxide N<sub>2</sub>O: 17</b>		<b>water H<sub>2</sub>O: 17</b>
<b>flange connection</b>	see end of the chapter / flanges	D3110-...F.



D3110-08BT, accessory: gauge

## Accessories, enclosed

<b>pressure gauge</b>	Ø 63 mm, 0...*2 mbar, G $\frac{1}{4}$ , capsule type	for G $\frac{1}{2}$ and G1 <b>MS6302-...*2</b>
	Ø 63 mm, 0...1 bar, G $\frac{1}{4}$ , Bourdon tube	for G $\frac{1}{2}$ and G1 <b>MS6302-01</b>
<b>gauge connection parts</b>		for G $\frac{1}{2}$ <b>AM-03S</b>
<b>mounting bracket</b>		for G $\frac{1}{2}$ <b>BW00-26S</b>
		for G1 <b>BW00-27S</b>

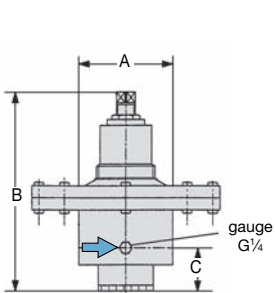

D3110-04..

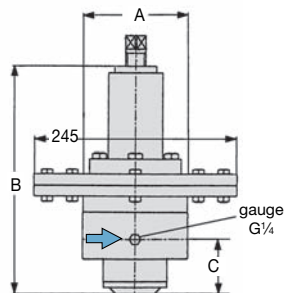

D3110-08..

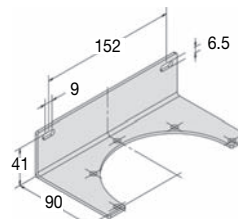

BW00-26S

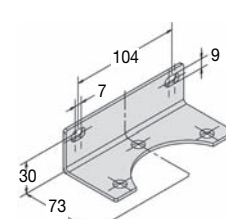

BW00-27S

\*1 at 6 bar overpressure and open outlet  
\*2 B6 = 0...60 mbar, C3 = 0...250 mbar



Order example:  
D3110-04AT

China website: www.duray-control.cn

