

Press Cap Centrifuge Tubes

I. APPLICATIONS

1. Cell centrifugation
2. Molecular biology
3. Sample storage
4. Centrifugation of precipitates

II. TUBE FEATURES

1. Materials: Strong polypropylene
2. Chemically resistant to alcohols and mild organic solvents
3. Transparent wall permits easy viewing of tube contents
4. Autoclavable
5. Tested to withstand centrifugation of 3,000 RCF in a fully supported rotor

III. TUBE DESIGN

1. Conical bottom design fits most standard floor model and table-top centrifuges
2. Molded graduations in 1ml increments up to 12ml
3. Clearly visible with either clear or turbid samples
4. 17mm diameter tube

IV. CAP DESIGN

1. Polyethylene press cap closure, fits 17mm diameter tubes

V. PACKAGING

1. Tubes: Bulk packaged, 1,000 tubes/case
2. Caps: Bulk packaged, 1,000 caps/case

VI. DESCRIPTION

Item	Description	Packaging	Sterile
10-0122	PP conical tubes	Bulk, 1,000 tubes/case	No
10-0123	PE press caps	Bulk, 1,000 caps/case	No

VII. STERILITY

1. N/A

VIII. CERTIFICATION

Biologix products are manufactured completely according to the TUV ISO 9001:2008 standard.

IX. RESTRICTIONS

Refer to the Chemical Resistance Chart in our catalog, and available within our online catalog.

X. PRODUCT PARAMETER

Dimensions=mm

Tube

- A** = 110.3
- B** = 90.2
- C** = 20.1
- D** = O.D. 7.8
- E** = O.D. 14.3
- F** = O.D.17.2

Cap

- A** = 20.1
- B** = 12.6
- C** = 7.5
- D** = O.D. 14.6
- E** = O.D. 16.9

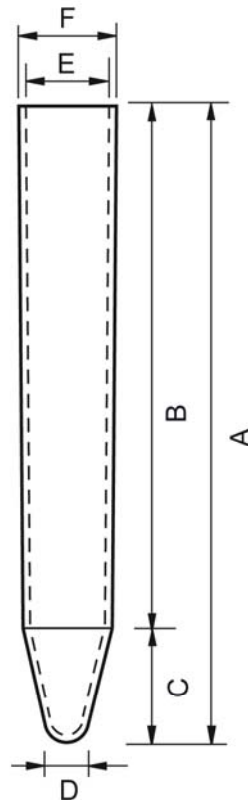

10-0122

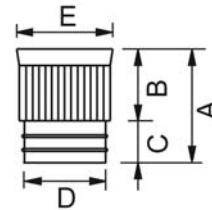

10-0123

