

Model: FN2011

测量范围(10KNN ~1000KN)

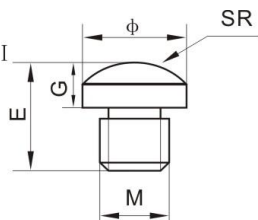

可选压头 I
Accessories I



压头 I 尺寸
Accessories I

尺寸/mm 量程/t	ϕ	G	E	M	SR
1~7	31	13	28	M16×1.5	30
10~25	38	28	55	M32×1.5	50
30~50	50	35	66	M40×1.5	80
60~100	76	45	80	M60×2	160

可选压头 II
Accessories II

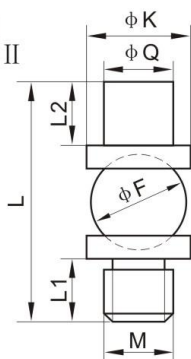

压头 II 尺寸
Accessories II

尺寸/mm 量程/t	L1	L2	M	ϕF	ϕK	ϕQ	L
1~7	15	15	M16×1.5	20	31	16	70
10~25	28	28	M32×1.5	27	38	30	118
30~50	35	35	M40×1.5	41.2	50	40	165
60~100	45	45	M60×2	63.5	76	60	210

技术参数 Technical Data	单位 Unit	
额定载荷 E_{max} (Rated Capacity)	KN	10,20,50,100
	KN	200, 500,1000
额定输出 (Rated Output)	mV/V	2.0±0.5%
综合精度 (Comprehensive precision)	%	0.05
零点平衡 (Zero Balance)	mV/V	0±0.1
温度对零点影响 (Temperature Effect On Zero)	%/10K	±0.05
非线性误差 (Non-Linearity)	%	±0.17
滞后误差 (Hysteresis Error)	%	±0.05
蠕变及蠕变恢复 (Creep/30 Min)	%	±0.18
输入电阻 (Input Resistance)	Ω	380±10
输出电阻 (Output Resistance)	Ω	350±3
参考电压 (Reference Excitation Voltage)	V	10
最大工作电压 (Maximum Excitation Voltage)	V	15
绝缘电阻 (Insulation Resistance)	G Ω /100V	>2
额定温度范围 (Nominal Temperature Range)	℃	-10~+40
工作温度范围 (Operating Temperature Range)	℃	-20~+50
储存温度范围 (Storage Temperature Range)	℃	-30~+70
安全承载 (Safe Load Limit)	%	150
极限承载 (Breaking Load)	%	200
材料 (Material)		Alloy steel
保护等级 (Protection class)		IP66

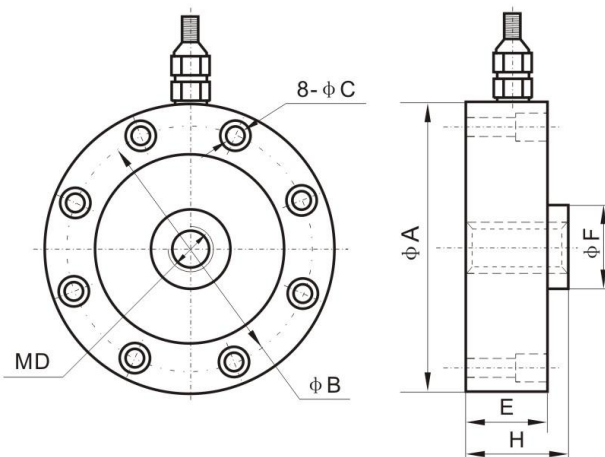

尺寸/mm 量程/t	ϕA	ϕB	ϕC	ϕF	MD	H	E
1~7	105	88.9	6.5	32	M16×1.5	45	37
10~25	125	101.6	8.5	39	M32×1.5	56	46
30~50	145	116.8	10.5	60	M40×1.5	65	54
60~100	205	162	12.5	76	M60×2	85	73

SPH (Shanghai) Industrial Sensor Ltd.

TEL: 86-21-5106-9888

FAX : 86-21-5106- 9009

www.yanatoo.com

su@yanatoo.com