

# LDP100 Series-Aluminum LED Driver 100W

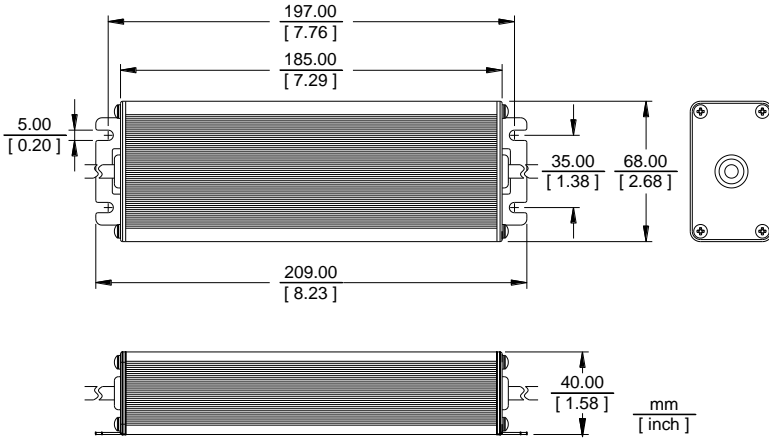

## Electrical specifications

### Input

Voltage ..... 90 - 305 Vac  
 Current ..... 1.3 Arms MAX.  
 Frequency ..... 47 - 63 Hz  
 Power factor ..... 90% MIN.  
 Total harmonic distortion 20% MAX.  
 Efficiency..... 88% typical

### Output

Voltage (Vo)..... (see table)  
 Power (Po)..... 96W Max.  
 Hold up time..... 10ms Min. full load, Vin 100 Vac  
 Line regulation..... 1%  
 Load regulation..... 5%  
 Over voltage protection... Shutdown latch mode  
 Over current protection.... 2 steps controlled current source  
 Short circuit protection..... Built-in  
 Ripple/Noise (mVpp)..... 2% (20MHz bandwidth)

## Output Electronic Specifications

| Model#        | Vo    | Io    | Po    | CC     |
|---------------|-------|-------|-------|--------|
| LDP100-180-00 | 18.0V | 4.80A | 86.4W | 12~18V |
| LDP100-240-00 | 24.0V | 4.00A | 96W   | 12~24V |
| LDP100-360-00 | 36.0V | 2.66A | 96W   | 18~36V |
| LDP100-480-00 | 48.0V | 2.00A | 96W   | 24~48V |

## Features

- Aluminum Case for IP65
- CEC-compliant performance
- Over voltage protection
- Over current protection
- Over temperature protection
- Constant voltage option (0~full load)
- Constant current option (as **CC** in table)
- Level B EMI filter
- High efficiency & High quality
- MTBF 100,000Hrs min. at 25°C ambient.

## Environmental

### Operating temperature

-20°C to +60°C ambient

### Storage temperature

-20°C to +80°C ambient

### Environmental protection

IP65 outdoor rated

## EMI

FCC class B  
 CISPR 22 class B

## Safety

UL1310 for class 2



1580 North Kellogg Drive, Anaheim, CA 92807  
 Tel: 714-917-0749 Fax: 714-917-0786 Website: [www.jasperelectronics.com](http://www.jasperelectronics.com)