

XB Series

- Tiny designed with built-in amplifier, for tiny objects detection.
- Equipped with sensitivity adjuster, excellent sensitivity.
- With Light ON and Dark ON two functions.
- All product are CE approved.



Item	Specifications							
Model number	XB-SP8MN		XB-SP8MP		XB-SR3MN		XB-SR3MP	
Sensing method	Through-beam				Retro-reflective			
Sensing distance	8M				3M			
Switching output	NPN NO & NC		PNP NO & NC		NPN NO & NC		PNP NO & NC	
Standard sensing object	Opaque 15mm				Opaque 75mm			
Model number	XB-CR50N	XB-CR50P	XB-CR25N	XB-CR25P	XB-CR10N	XB-CR10P		
Sensing method	Diffuse-reflective							
Sensing distance	50cm			25cm		10cm		
Switching output	NPN NO & NC	PNP NO & NC	NPN NO & NC	PNP NO & NC	NPN NO & NC	PNP NO & NC		
Standard sensing object	White Paper 200x200mm			White Paper 100x100mm		White Paper 80x80mm		
Operating voltage	DC 12~24V±10%							
Response time	<5ms							
Load current	<100mA							

Light source	Infrared LED
Operation indicator	Red LED
Circuits protection	Reversed polarity & Short circuit protection
Enclosure protection	IEC IP65
Ambient temperature & humidity range	Operating : -20 ~ 55°C / RH 35 ~85% (with no icing or condensation)
Ambient illumination	Lamplight < 3000 Lux / Sunlight < 10000 Lux
Housing material	Case : ABS / Lens : Acrylic
Connecting method	Pre-wired 2M Cable
Accessories	Mounting bracket · Screws · Adjustment screwdriver Reflector(only for Retro-reflective)

Dimension

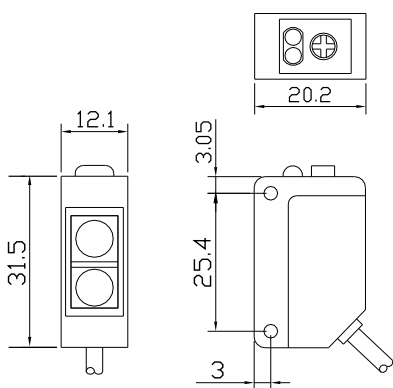

Wiring Diagram

Emitter of Thru-beam

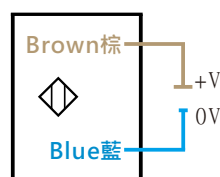

NPN NO & NC Type

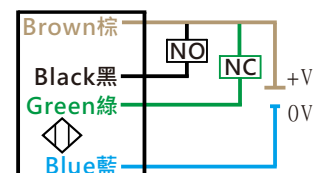

PNP NO & NC Type

