

Special Features

2000 Watt Output Power
Power Density 31 W/Inch³
Efficiency (Typ.) > 95%
Digital Multiphase Booster (Patent Pending)
Output Voltage Digital Adjustment
Operating Temperature: -25°C to +50°C
Cooling with internal fan (temperature controlled)
Thermal Shutdown
Inrush current doesn't exceed the values stated in ETS 300 132-1, paragraph 4.7



Applications

ITC Equipment (IT, Telecommunication, Networking)

Input Specifications

Input Voltage	-48 Vdc (-38.4 V to -57.6 V), -60 Vdc (-48V to -72 V)
Maximum Input Current	56A @ -38,4 Vdc
Input Protection	80 A Internal fuse

Output Specification

Maximum Output Power	2000 W
Output Voltage	Vout = -65 Vdc (38.4 Vdc < Vin < 65 Vdc) Vout = Vin (Vin ≥ 65 Vdc)
Output Current	1 to 31.4 A
Voltage Regulation	±1%
Ripple	<200 mVpp
Efficiency	≥93% (Full Load @ 38.4 V < Vin < 65 V) ≥96% (Full Load @ 65V < Vin < 72 V)

Protections

Input Reverse Polarity
Input Under Voltage
Input Over Voltage
Output Under Voltage
Output Over Voltage
Output Over Current
Output Short Circuit
Over Temperature

temperature controlled Fan speed + Thermal Shutdown

Features

Soft Start
Output Voltage Digital Adjustment
Power Good Signal
Input Under Voltage Alarm
Output Over Voltage Alarm
Output Under Voltage Alarm
Over Temperature Alarm
Fan Fault Alarm

Environmental

Operating Temperature

-25 to +50 °C Full Load (Outside this range PS complies with
ETS 300 019 Jul1991 Class 1.3, 2.3, 3.3)

Cooling

Internal Fan (temperature controlled speed for lower acoustic noise,
extended life performances)

Safety

Safety Standards

IEC 60950-1 Ed1.0 (2001); UL 60950-1:2003 First Edition, CSA 22.2
No 60950-1-03 First Edition

Eu and RoW

ROAL Electronics S.p.A
Via Jesina 56/A
60022 – Castelfidardo (AN) - Italy
Tel:+39 071 721461
Fax:+ 39 071 72146 480
www.roallivingenergy.com

North America

ROAL Electronics USA, Inc.
701, Main St. Suite 405
Stroudsburg, PA18360
Phone: + 1 570 421 5750
Fax: +1 570 421 5687
Rev. 01 Jun 07 – Pag. 2/3

EMC Compliance

Conducted & Radiated Immunity	EN55022 Class A
Harmonic Distortion	EN55024
Electrostatic Discharge	EN61000-3-2
Radiated RFI	EN61000-4-2
Fast Transients/bursts	EN61000-4-3
Input Line surges	EN61000-4-4
Conducted RFI	EN61000-4-5
Voltage Dips	EN61000-4-6
EMC Test for Telecommunication	EN61000-4-11
	ETS 300 132-1/ -2

Physical Specification

Case	Fully enclosed metal box IP20 conform
Dimensions	186 mm x 100 mm x 69 mm = 7.3 in x 3.9 in x 2.7 in
Weight	<2 Kg = <4.4 lb

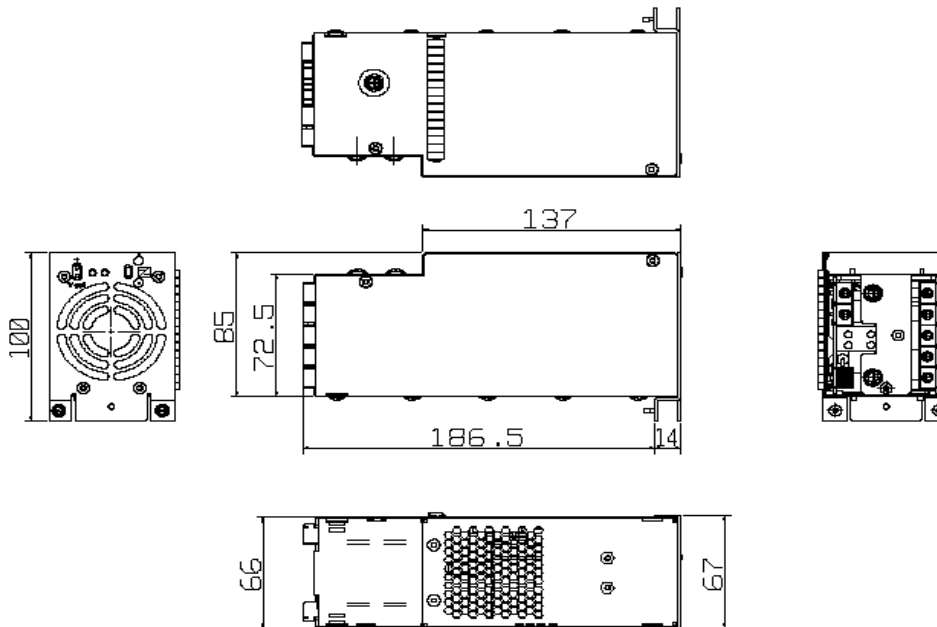

Roal Electronics, S.p.A. may change product specifications and accordingly the information presented in this document. Customers are responsible for their products and applications using Roal Electronics, S.p.A. products. Roal Electronics, S.p.A. assumes no liability from the use of its products outside of specifications. No license is granted to any intellectual property rights by this document. ROAL ELECTRONICS, S.P.A. DISCLAIMS ALL REPRESENTATIONS AND WARRANTIES OF ANY KIND, EXPRESS OR IMPLIED, INCLUDING, BUT NOT LIMITED TO, IMPLIED WARRANTIES OF NONINFRINGEMENT, MERCHANTABILITY AND FITNESS FOR A PARTICULAR PURPOSE.

Eu and RoW

ROAL Electronics S.p.A.
Via Jesina 56/A
60022 – Castelfidardo (AN) - Italy
Tel: +39 071 721461
Fax: +39 071 72146 480
www.roallivingenergy.com

North America

ROAL Electronics USA, Inc.
701, Main St. Suite 405
Stroudsburg, PA18360
Phone: +1 570 421 5750
Fax: +1 570 421 5687
Rev. 01 Jun 07 – Pag. 3/3