

H35

Beam Load Cell



Special Features

- Capacity range from 500 to 10,000 Lbs.
- Stainless steel construction
- 3 mV/V output, 350 ohm bridge
- Hermetically sealed
- NTEP-certified

Dimensions: inch (mm)

| MAXIMUM CAPACITY (lbs) | A1 | A2 | A3 | A4 | B | C | D | E | F | G | H | J |
|------------------------|---------------|-------------|-------------|-------------|-------------|-------------|--------------|-------------|-------------|-------------|-------------|------------|
| 500, 1K, 2.5K, 4K, 5K | 1/2-20 UNF-2B | 0.62 (15.7) | 0.53 (13.5) | 0.53 (13.5) | 1.21 (30.7) | 1.12 (28.5) | 5.12 (130.0) | 1.00 (25.4) | 3.00 (76.2) | 0.50 (12.7) | 2.27 (57.7) | 0.07 (1.7) |
| 10K | 3/4-16 UNF-2B | 0.75 (19.1) | 0.78 (19.8) | 0.78 (19.8) | 1.44 (36.8) | 1.34 (34.0) | 6.75 (171.5) | 1.50 (38.1) | 3.75 (95.3) | 0.75 (19.1) | 3.00 (76.2) | 0.10 (2.8) |

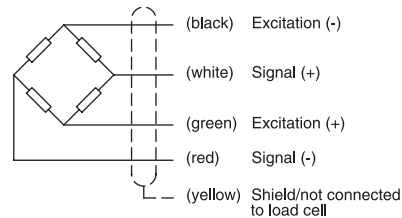
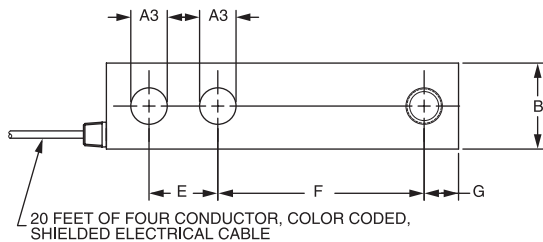
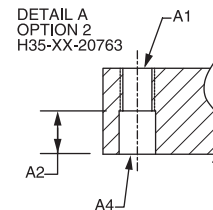
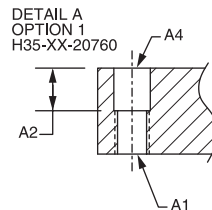
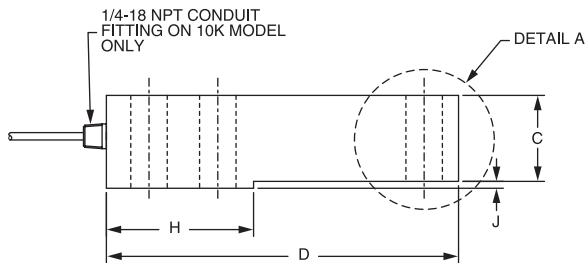

Specifications

| Model Type | | H35 | | | | | |
|---|----------------------|-------------------------|------|------|------|------|------|
| Accuracy class | | NTEP Class III | | | | | |
| Maximum number of load cell intervals (n_{LC}) | | 5000 Divisions Multiple | | | | | |
| Maximum capacity (E_{max}) | lb | 500 | 1K | 2.5K | 4K | 5K | 10K |
| Minimum load cell verification interval (V_{min}) | lb | 0.05 | 0.10 | 0.25 | 0.40 | 0.50 | 1.00 |
| Sensitivity (C_n) | mV/V | 3.0 ± .003 | | | | | |
| Zero balance | | 0.0 ± .060 | | | | | |
| Temperature effect on zero balance (TK_0) | % of C_n / 10°C | ± .02 | | | | | |
| Temperature effect on sensitivity (TK_c) ¹⁾ | | | | | | | |
| Temperature range +20...+40°C [+70...+105°F] -10...+20°C [+15...+70°F] | | ± .0175 ± .0117 | | | | | |
| Hysteresis error (d_{hy}) ¹⁾ | % of C_n | ± 0.02 | | | | | |
| Non-linearity (d_{lin}) ¹⁾ | | ± 0.02 | | | | | |
| Creep (d_{cr}) over 30 min. | | ± 0.03 | | | | | |
| Input resistance (R_{LC}) | Ω | >385 | | | | | |
| Output resistance (R_O) | | 350 ± 1.5 | | | | | |
| Reference excitation voltage (U_{ref}) | V | 5 | | | | | |
| Maximum excitation voltage (U_{max}) | | 15 | | | | | |
| Insulation resistance (R_{is}) | GΩ | >5 | | | | | |
| Nominal temperature range (B_T) | °C [°F] | -10...40 [14...104] | | | | | |
| Service temperature range (B_{tu}) | | -15...70 [5...158] | | | | | |
| Storage temperature range (B_{tl}) | | -15...85 [5...185] | | | | | |
| Safe load limit (E_L) | % of E_{max} | 150 | | | | | |
| Ultimate load limit (E_d) | | 300 | | | | | |
| Lateral load limit (E_{lq}) | | 100 | | | | | |
| Permissible dynamic load (F_{srel}) (vibration amplitude according to DIN 50100) | | 70 | | | | | |
| Deflection at E_{max} (S_{nom}), approx. | in | 0.02 | | | | | |
| Weight, approx. | lbs | 2.5 | | | | | 5.0 |
| Protection class to EN60529 (IEC529) | | IP 68 | | | | | |
| Material: Measuring element | | Stainless Steel | | | | | |
| Cable Fitting Gland | | Silicone | | | | | |
| Cable Sheath | | Polyurethane | | | | | |
| Coating/Plating | | Electro-polished | | | | | |

¹⁾ The sum of data for Non-linearity, Hysteresis and Temperature effect on sensitivity meets the requirements of NTEP HB44.



Due to continuous improvement, dimensions and specifications are subject to change without notice. All details describe our products in general form only. They are not to be understood as express warranty and do not constitute any liability whatsoever. Please request certified drawings before designing mountings or fixtures.

HBM, Inc.

19 Bartlett Street
Marlborough, MA 01752
Tel. 800-578-4260 • 508-624-4500
Fax 508-485-7480
E-mail: info@usa.hbm.com
Internet: www.hbm.com



measurement with confidence