

SSL SERIES

0.5mm PITCH CONNECTOR FOR MICRO COAXIAL CABLE

RoHS
Compliant

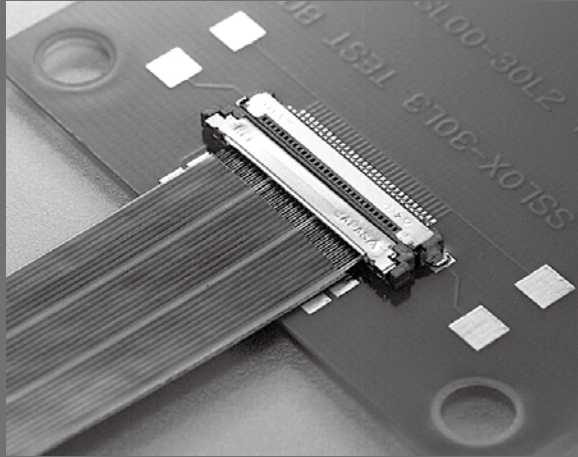

FEATURES

- ▶ Compact connector with a low profile of 1.4 mm(0.055") and a mating width of 6.08 mm(0.239").
- ▶ For micro coaxial cable(#40 AWG).
- ▶ IDC of contacts all together is adopted for improved connection reliability and more compact connectors.
- ▶ Equipped with a metal shell, noise reduction and product strength are ensured.
- ▶ Multiple ground terminals are provided for enhanced transmission characteristics and EMS protection.
- ▶ Highly reliable design with effective contact displacement of 0.5mm(0.020").

ORDER CODE

SSL0 - -

① ② ③ ④

*Please order in multiples of the quantity per package.

- ① **[Type]** Receptacle (PCB side connector) **SSL00** : without positioning posts **SSL01** : with positioning posts (Right angle only)
- ② **[Number of contacts]** 10 : 10 pin 20 : 20 pin 30 : 30 pin 40 : 40 pin
- ③ **[Contact tail style]** L3 : Right angle S : Straight
- ④ **[Number of packaging]** 0500 : 500pcs./1 reel 1000 : 1000pcs./1 reel 1500 : 1500pcs./1 reel(Straight only) 3000 : 3000pcs./1 reel (Right angle only)

ORDER CODE

SSL20 - **S B**

① ② ③ ④

*Please order in multiples of the quantity per package.

- ① **[Type]** **SSL20** : Plug (cable side connector)
- ② **[Number of contacts]** 10 : 10 pin 20 : 20 pin 30 : 30 pin 40 : 40 pin
- ③ **[Cable exit style]** S : Straight
- ④ **[Recommended cable]** B : Micro coaxial cable(#40 AWG)

* Plug (cable side connector) is composed of base and shell.

SPECIFICATIONS

| Material and plating | | Electrical Characteristics | |
|----------------------|----------------------------------------------|---------------------------------|------------------------------|
| Insulator material | Glass-filled LCP(UL94V-0),Black | Current rating | 0.3A per contact |
| Contact material | Copper alloy | Contact resistance | 100mΩ max. |
| Contact plating | Gold over Nickel | Dielectric withstanding voltage | 200V AC for 1minute |
| Shell material | Copper alloy | Insulation resistance | 100MΩ min.at 250V DC |
| Shell plating | Tin copper over Nickel | Operating temperature | -40°C to +85°C |
| IDC cover material | [SSL20]Glass-filled LCP (UL94V-0), Off-white | Recommended cable | #40 AWG Micro coaxial cables |

Mating Drawing

Unit : mm(inch)

◆ Horizontal Mating

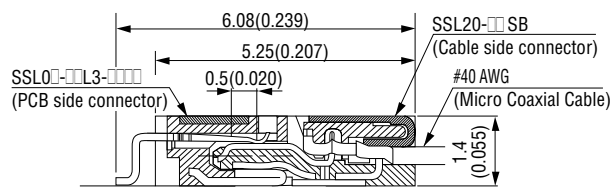

◆ Vertical Mating

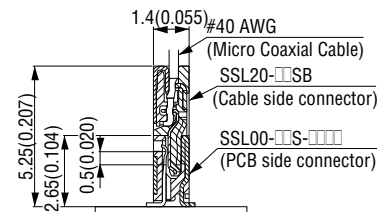

SSL0□-□□L3-□□□□ (Receptacle, PCB side connector, Right angle)

Unit : mm(inch)

► Printed Circuit Board Layout (Component Side View)

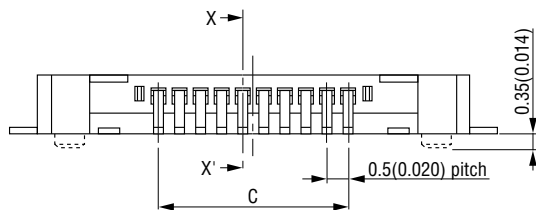
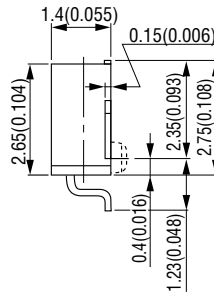
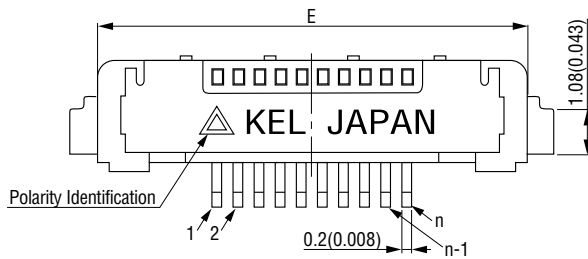
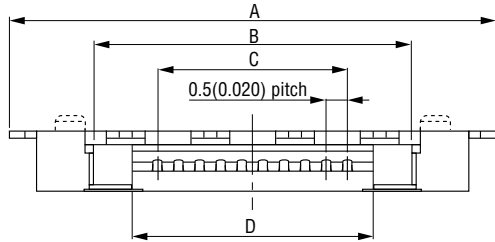
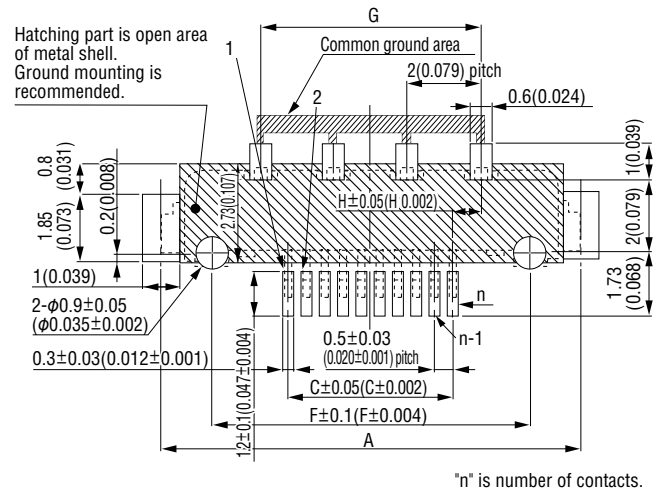

X-X' Cross Section

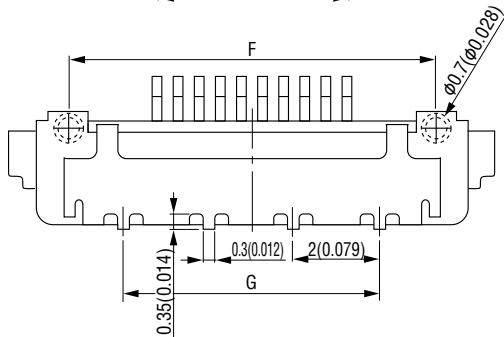
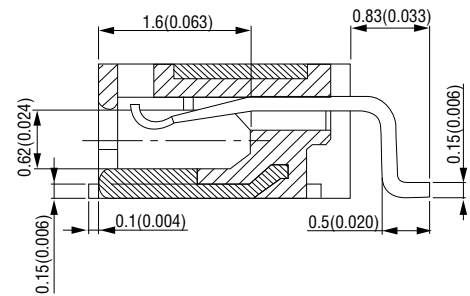

► Ground Installation

| No. of contacts | No. of ground |
|-----------------|---------------|
| 10 | 6 |
| 20 | 8 |
| 30 | 11 |
| 40 | 13 |

Packaging style

Embossed tape

► Product Table

| Part Number | Number of packaging |
|-----------------|---------------------|
| SSL0□-□□L3-0500 | 500 |
| SSL0□-□□L3-1000 | 1,000 |
| SSL0□-□□L3-3000 | 3,000 |

► Product Table / Dimensions

| No. of contacts | Part Number | A | B | C | D | E | F | G | H |
|-----------------|-----------------|-----------------|-----------------|-----------------|-----------------|-----------------|-----------------|-----------------|-----------------|
| 10 | SSL0□-10L3-□□□□ | 11.4 (0.449) | 7.5 (0.295) | 4.5 (0.177) | 5.7 (0.224) | 10.1 (0.398) | 8.6 (0.339) | 6.0 (0.236) | 0.75 (0.030) |
| 20 | SSL0□-20L3-□□□□ | 16.4 (0.646) | 12.5 (0.492) | 9.5 (0.374) | 10.7 (0.421) | 15.1 (0.594) | 13.6 (0.535) | 10.0 (0.394) | 0.25 (0.010) |
| 30 | SSL0□-30L3-□□□□ | 21.4 (0.843) | 17.5 (0.689) | 14.5 (0.571) | 15.7 (0.618) | 20.1 (0.791) | 18.6 (0.732) | 16.0 (0.630) | 0.75 (0.030) |
| 40 | SSL0□-40L3-□□□□ | 26.4 (1.039) | 22.5 (0.886) | 19.5 (0.768) | 20.7 (0.815) | 25.1 (0.988) | 23.6 (0.929) | 20.0 (0.787) | 0.25 (0.010) |



SSL00-□□S-□□□□ (Receptacle, PCB side connector, Straight)

Unit : mm(inch)

► Printed Circuit Board Layout (Component Side View)

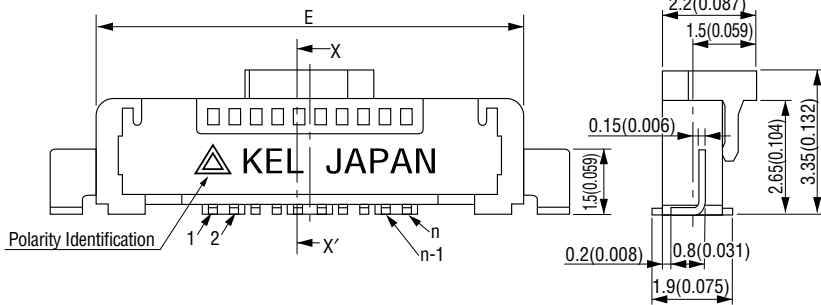
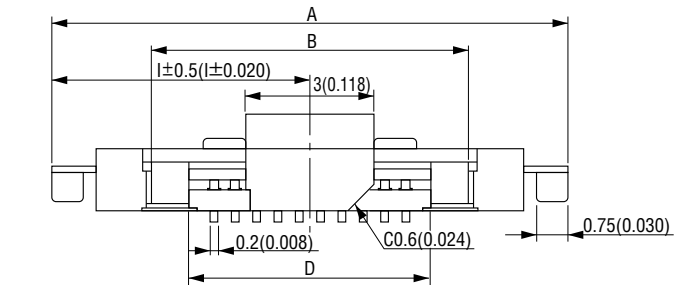
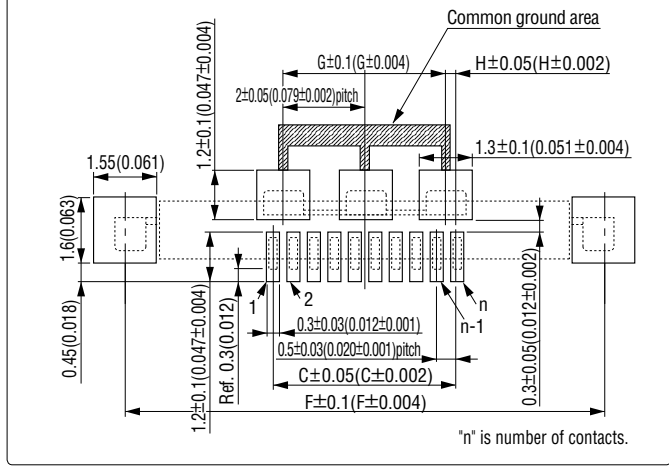

X-X' Cross Section

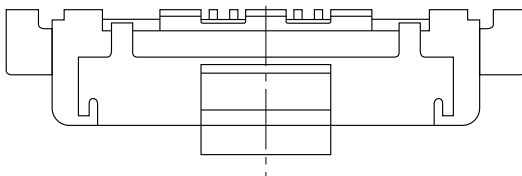
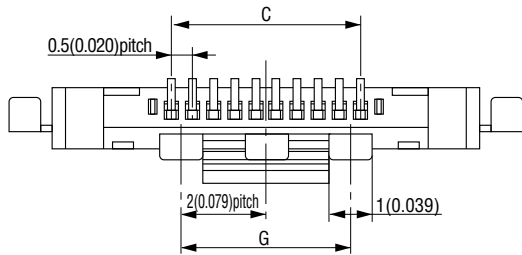
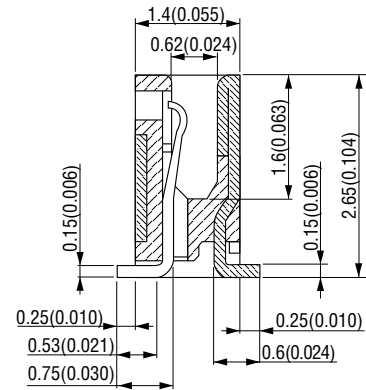

► Ground Installation

| No. of contacts | No. of ground |
|-----------------|---------------|
| 10 | 5 |
| 20 | 7 |
| 30 | 10 |
| 40 | 12 |

Packaging style

Embossed tape

► Product Table

| Part Number | Number of packaging |
|----------------|---------------------|
| SSL00-□□S-0500 | 500 |
| SSL00-□□S-1000 | 1,000 |
| SSL00-□□S-1500 | 1,500 |

► Product Table / Dimensions

| No. of contacts | Part Number | A | B | C | D | E | F | G | H | I |
|-----------------|----------------|-----------------|-----------------|-----------------|-----------------|-----------------|------------------|-----------------|-----------------|-----------------|
| 10 | SSL00-10S-□□□□ | 12.2 (0.480) | 7.5 (0.295) | 4.5 (0.177) | 5.7 (0.224) | 10.1 (0.398) | 11.75 (0.463) | 4.0 (0.157) | 0.25 (0.010) | 6.1 (0.240) |
| 20 | SSL00-20S-□□□□ | 17.2 (0.677) | 12.5 (0.492) | 9.5 (0.374) | 10.7 (0.421) | 15.1 (0.594) | 16.75 (0.659) | 8.0 (0.315) | 0.75 (0.030) | 8.6 (0.339) |
| 30 | SSL00-30S-□□□□ | 22.2 (0.874) | 17.5 (0.689) | 14.5 (0.571) | 15.7 (0.618) | 20.1 (0.791) | 21.75 (0.856) | 14.0 (0.551) | 0.25 (0.010) | 11.1 (0.437) |
| 40 | SSL00-40S-□□□□ | 27.2 (1.071) | 22.5 (0.886) | 19.5 (0.768) | 20.7 (0.815) | 25.1 (0.988) | 26.75 (1.053) | 18.0 (0.709) | 0.75 (0.030) | 13.6 (0.535) |

SSL20-□□SB (Plug, Cable side connector)

Unit : mm(inch)

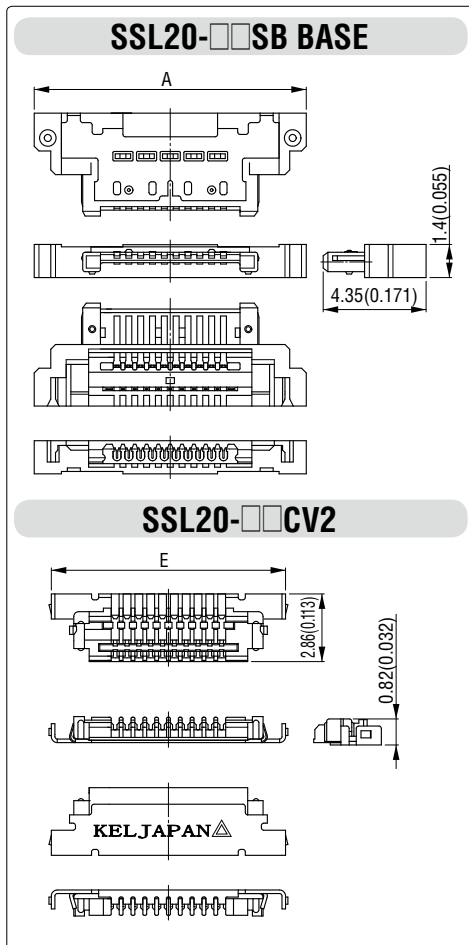

*SSL20-□□SBBASE and SSL20-□□CV2 are component parts of SSL20-□□SB.

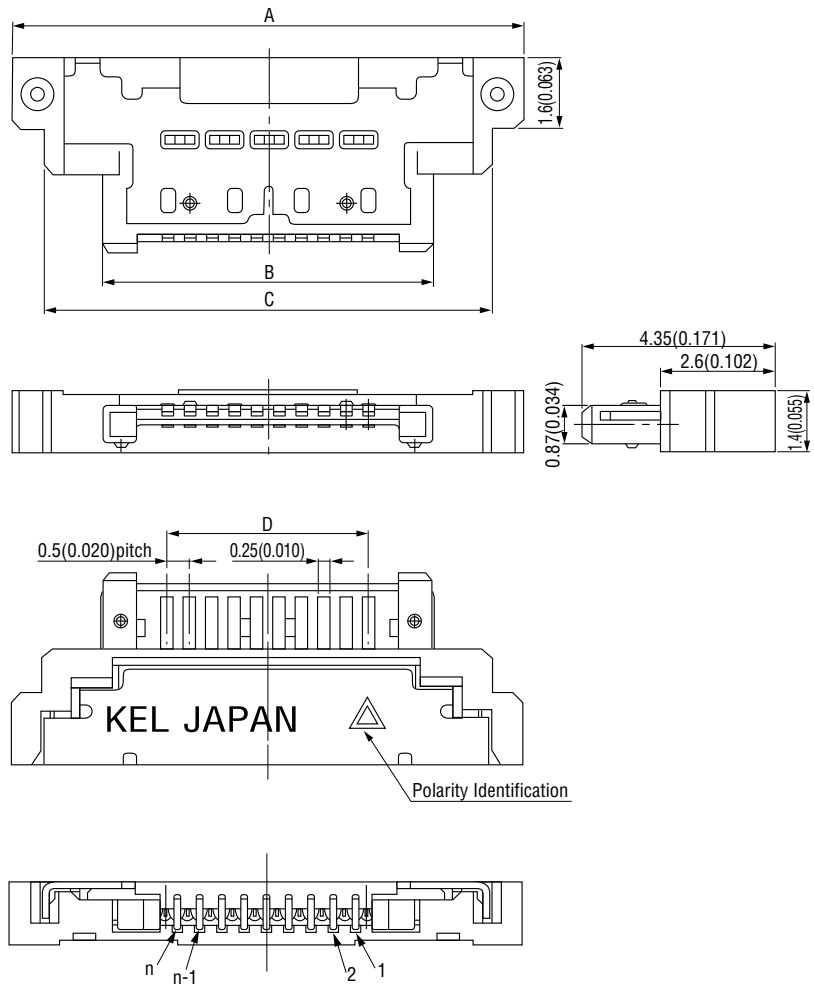

"n" is number of contacts.

| |
|-----------------|
| Packaging style |
| Tray |

► Product Table / Dimensions

| No. of contacts | Part Number | A | B | C | D | E | Number of packaging |
|-----------------|-------------|-----------------|-----------------|-----------------|-----------------|-----------------|---------------------|
| 10 | SSL20-10SB | 11.5 (0.453) | 7.5 (0.295) | 10.1 (0.398) | 4.5 (0.177) | 9.9 (0.390) | 160 |
| 20 | SSL20-20SB | 16.5 (0.650) | 12.5 (0.492) | 15.1 (0.594) | 9.5 (0.374) | 14.9 (0.587) | 120 |
| 30 | SSL20-30SB | 21.5 (0.846) | 17.5 (0.689) | 20.1 (0.791) | 14.5 (0.571) | 19.9 (0.783) | 100 |
| 40 | SSL20-40SB | 26.5 (1.043) | 22.5 (0.886) | 25.1 (0.988) | 19.5 (0.768) | 24.9 (0.980) | 80 |

CABLE ASSEMBLY

ORDER CODE

SSL20- **SSB-** **(** **)**

①
②
③
④
⑤
⑥
⑦
⑧
⑨

- ① **[Type]** SSL20 : Plug (Cable side connector)
- ② **[Number of contacts]** 10 : 10 pin 20 : 20 pin 30 : 30 pin 40 : 40 pin
- ③ **[Cable exit style(Left side, CN1)]** S : Straight
- ④ **[Cable exit style(Right side, CN2)]** S : Straight
- ⑤ **[Recommended Cable]** B : #40 AWG micro coaxial cable
- ⑥ **[Cable length(cm)]** L : Dimension (Example:013.5=13.5cm)
- ⑦ **[Wiring code]** B : Pin 1 to Pin 1 C : Pin 1 to Pin n
- ⑧ **[Laminated tape]** Omit : Without tape H : With tape
- ⑨ **[Quantity]** (B) : 10 to 49pcs (C) : 50 to 99pcs (D) : 100pcs or more

*Applicable cable length : 5 to 100cm Minimum cable length for SSL20-□□SSB-□□□□-□-□-□-□-□-□ : 7cm

►CABLE ASSEMBLY STYLE

Unit : mm(inch)

Wiring Code :
Pin 1 to Pin 1

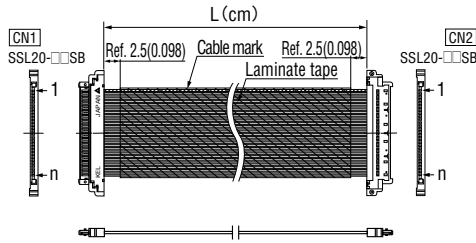

* "n" is number of contacts.

Wiring Code :
Pin 1 to Pin n

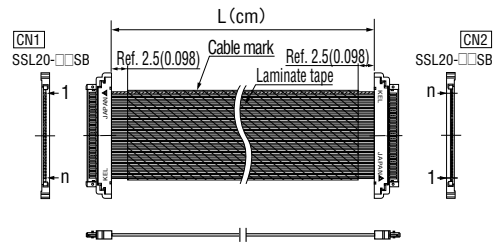

* "n" is number of contacts.

*Please contact your local KEL sales office for inquiries regarding cable length and tolerance.

*Laminated tape is designed to be a little wider than the cable width. Please contact your local KEL sales office for further details.